

G.F.R.C. Pole Gun P/N 19-127

Warning:

Do not tight clear hose to the gun body with any kind of clamps at any time. This feature allows the gun to be disconnected in case of tip clogging to relief back pressure from material hose and pump hose.

Note:

Always turn air first and then turn material pump to alimanet material back flow into air holes.

Connect water hose to item 13 to rinse water trough tip 2 to clear air holes from material that been use.

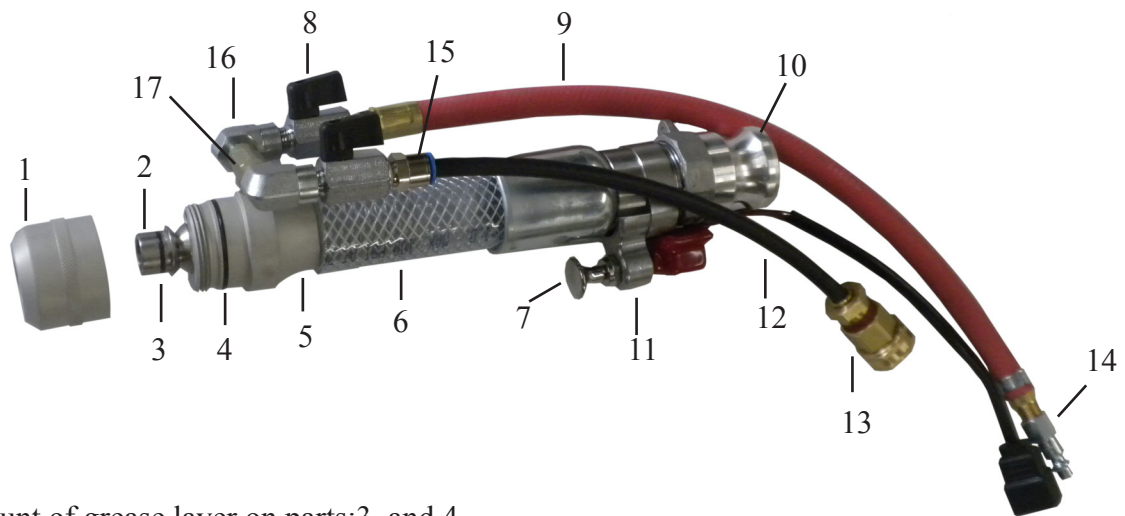

Note:

Keep small amount of grease layer on parts:3, and 4 it will make part 1 tip holder install and remove easily.

1. Tip holder
2. Material tip
3. Tip O-ring
4. Gun Body O-ring
5. Gun body
6. Hose assy
7. Switch
8. Valve
9. Air hose
10. Quick Cam and Grove
11. Switch Bracket
12. Water hose
13. Water hose connector
14. Air fitting
15. Hose Fitting
16. Street elbow
17. Tee